

# *Conference Center of the Americas*

## Meeting Facilities

# 1 s t F l o o r

Parking Lot

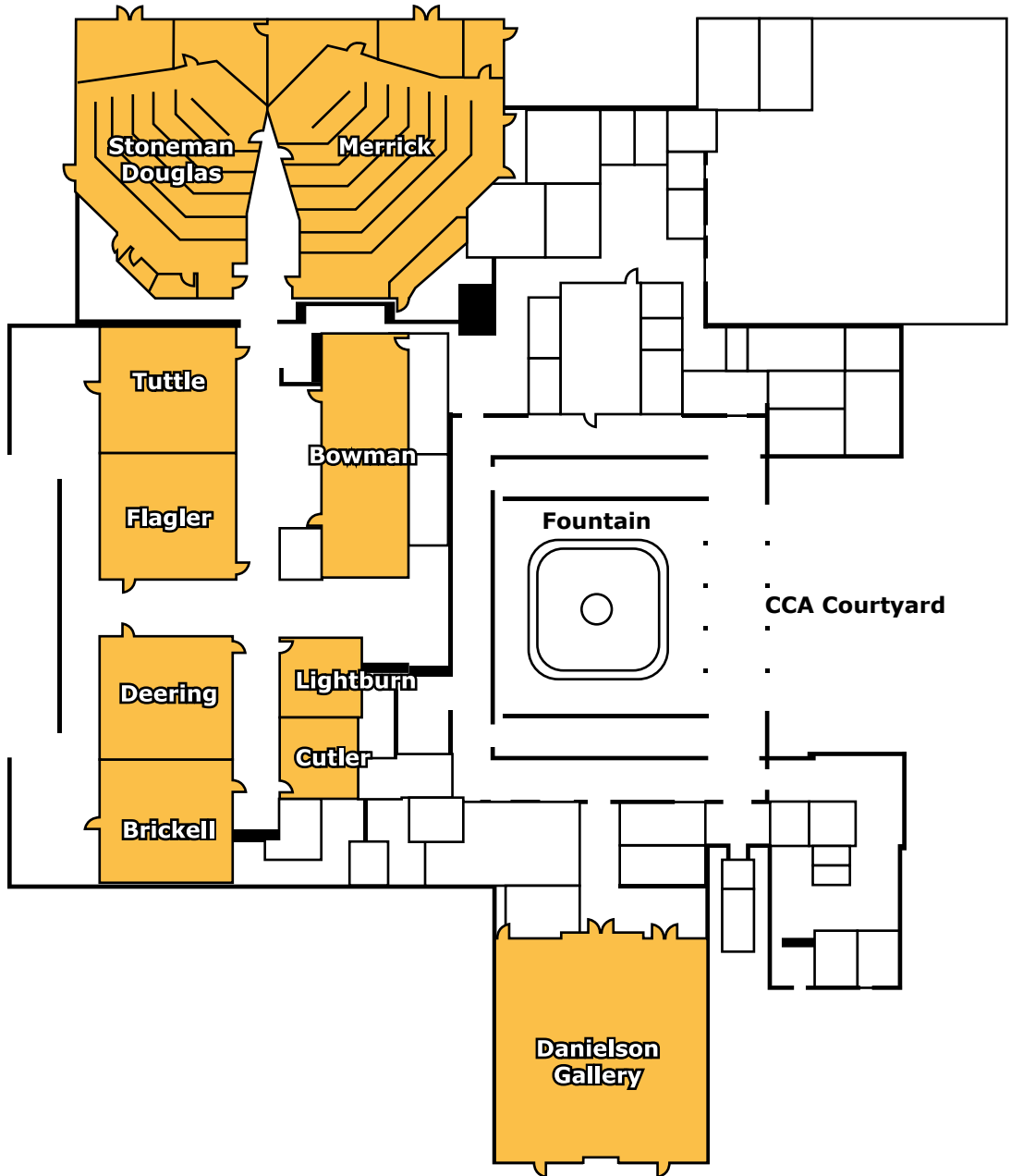

# Conference Center of the Americas

## Meeting Facilities

### Conference Center

The Conference Center of the Americas is a world-class conference and education center featuring an array of technologically advanced facilities and amenities. The CCA enhances the Biltmore Hotel with 40,000 square feet of exceptional, technologically-supported function space that includes eight main meeting rooms, six breakout rooms, a 6,528 sq. ft. Ballroom, two, state-of-the-art amphitheaters, and a private executive boardroom.

The Biltmore's conference facilities offer the latest in advanced conference technologies, including Direct-In-Dial (DID) capability; soundproof simultaneous interpreters booths and simultaneous translation; wireless audience response devices; dual rear-screen projection in three major rooms; three-line ISDN videoconference ready; Internet connectivity between each room; Ethernet access for T1 broadband Internet in all rooms plus four-star standards of room service, control and comfort.

### 1st Floor

Room	Sq. Ft.	Conference	Reception	Theatre	Classroom	U-Shape	H. Sq.	Rounds
<b>Stoneman Douglas</b>	-	-	-	-	60	-	-	-
<b>Merrick</b>	-	-	-	-	90	-	-	-
<b>Tuttle</b>	929	18	-	60	32	24	30	32
<b>Flagler</b>	871	16	-	48	28	18	20	24
<b>Bowman</b>	1271	40	-	88	54	44	48	80
<b>Deering</b>	871	16	-	48	28	18	20	24
<b>Brickell</b>	934	18	-	60	32	24	30	32
<b>Cutler</b>	388	10	-	21	12	12	16	16
<b>Lightburn</b>	385	10	-	21	12	12	16	16
<b>Danielson Gallery</b>	2933	44	-	180	72	50	58	180

# 2 n d F l o o r

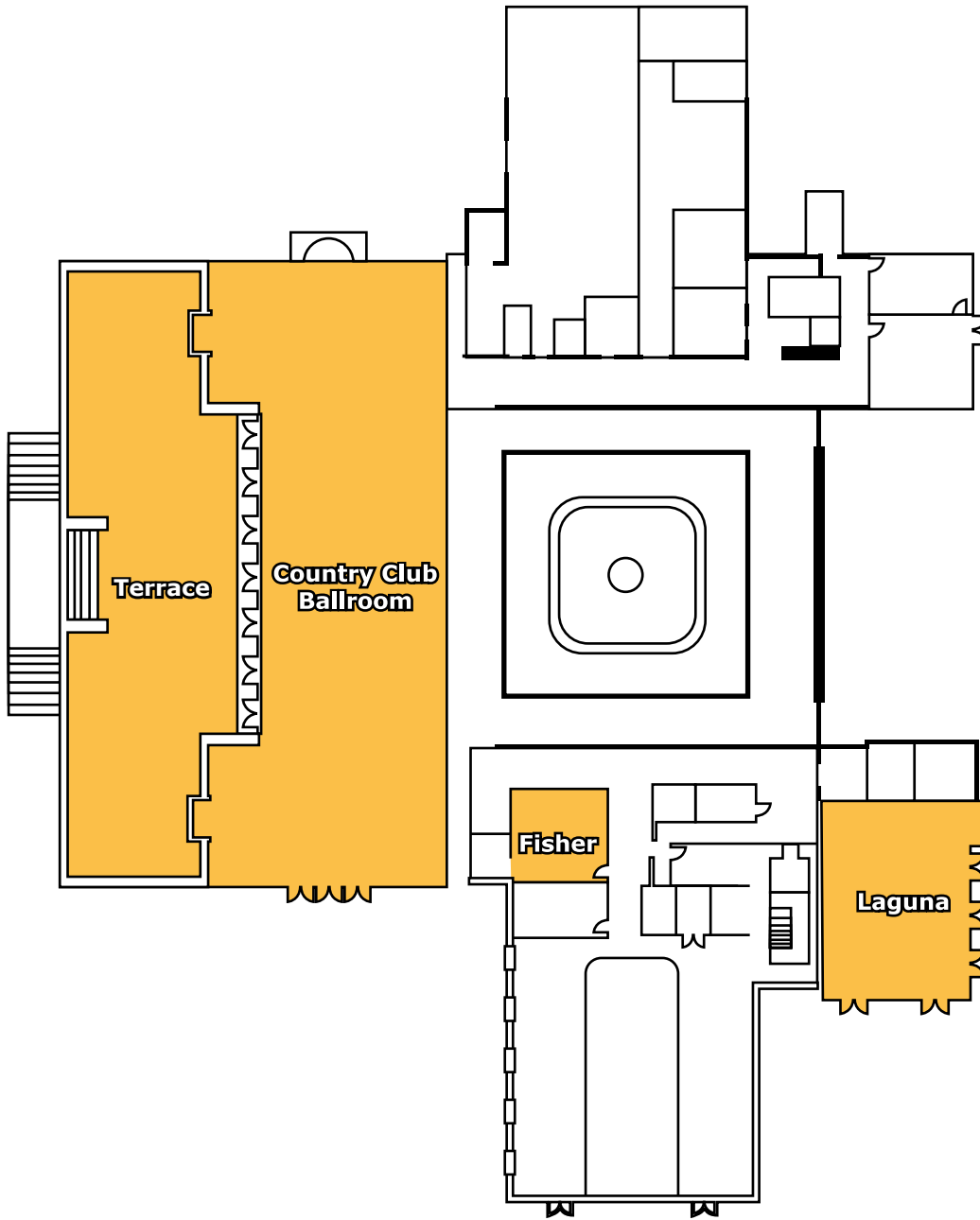

# 3 r d F l o o r

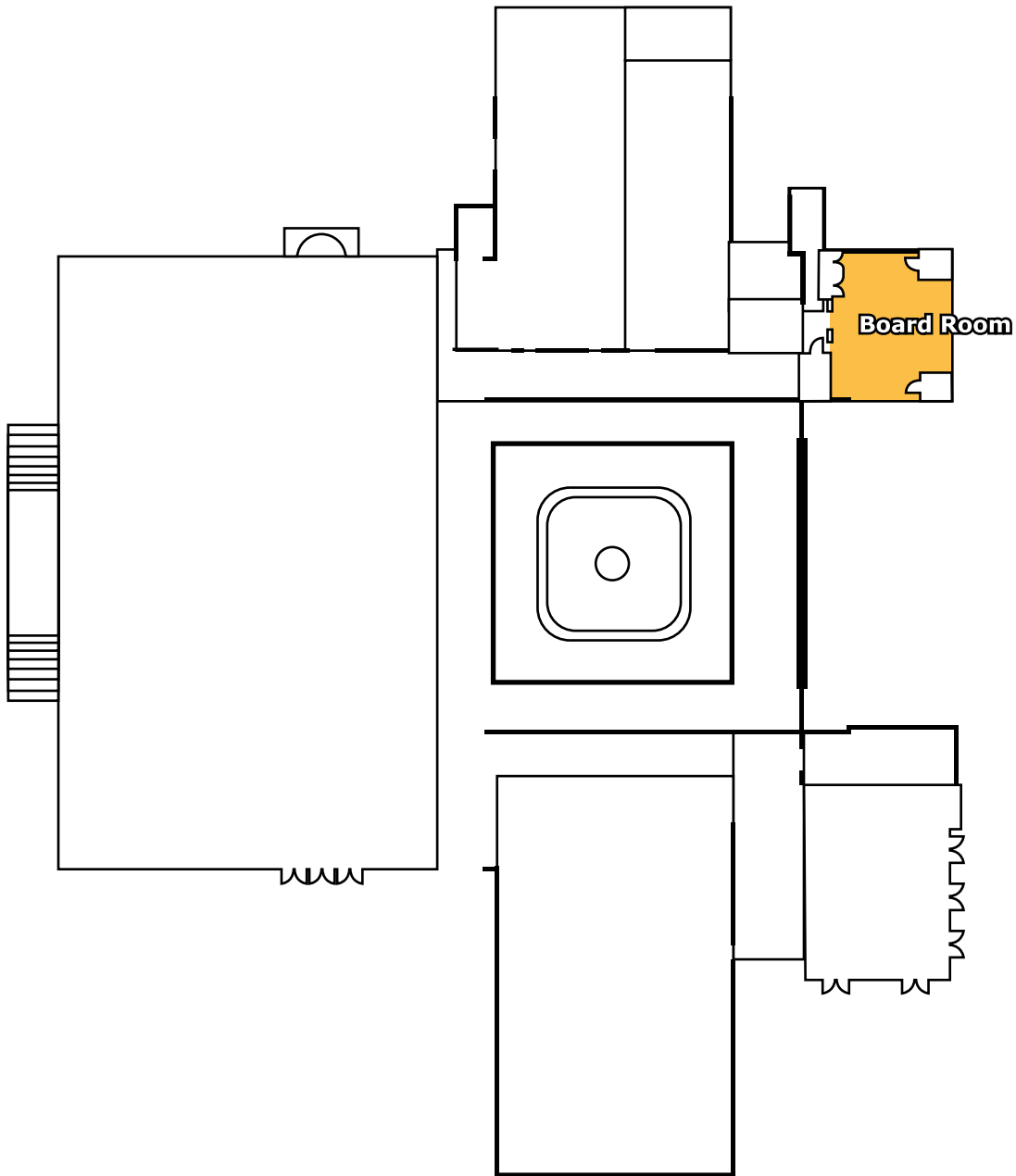

# Conference Center of the Americas

Meeting Facilities

## 2nd Floor

Room	Sq. Ft.	Conference	Reception	Theatre	Classroom	U-Shape	H. Sq.	Rounds
Country Club Ballroom	6528	124	1000	600	325	130	140	540
Country Club Ballroom Terrace	5560	-	1000	475	-	-	-	430
Fisher	378	14	-	32	12	-	-	16
Laguna	1472	40	-	90	32	-	-	110

## 3rd Floor

Room	Sq. Ft.	Conference	Reception	Theatre	Classroom	U-Shape	H. Sq.	Rounds
Board Room	686	18	-	-	-	-	-	-