

# MIAMI'S BEST ADDRESS

The Biltmore offers exceptional facilities and amenities for meetings and special events, highlighted by luxurious and highly flexible accommodations, state-of-the-art conference technology, top-notch catering and highly personalized service.

## UNIQUE BILTMORE DETAILS

- 273 luxurious guest rooms, including 36 specialty suites
- 76,000 square feet of indoor/outdoor meeting and function space
- 3 grand ballrooms, 2 state-of-the-art amphitheatres, executive boardroom and a total of 26 function rooms
- Within minutes of South Beach, Coconut Grove, Downtown Miami and local area attractions.
- Valet and complimentary self-parking
- Destination management, audiovisual and transportation companies all offered on property
- Complimentary high speed internet in all areas

## AMENITIES

- Diverse selection of dining experiences including Palme d'Or; the 2011 Top Zagat Rated Restaurant
- Donald Ross designed 18-hole championship golf course
- 12,000 sq. ft. full service spa with 12 treatment rooms and private spa suite
- Full service fitness center offering over 120 classes per week, private training and state-of-the-art equipment
- Recreational Culinary Academy offering team-building and private classes
- Largest hotel pool in the continental US surrounded by 9 private poolside cabana suites
- Ten lighted tennis courts for night play
- An array of activities including shopping, high tea and nightly entertainment
- Total Performance Golf – A Titleist program designed to improve your golf swing

# Biltmore

CORAL GABLES ~ MIAMI

GOLF / SPA / TENNIS / FITNESS / FINE DINING

1200 ANASTASIA AVENUE, CORAL GABLES MIAMI, FLORIDA 33134

1.800.727.1926 • BILTMOREHOTEL.COM



# CONFERENCE ROOMS AND MEETING FACILITIES

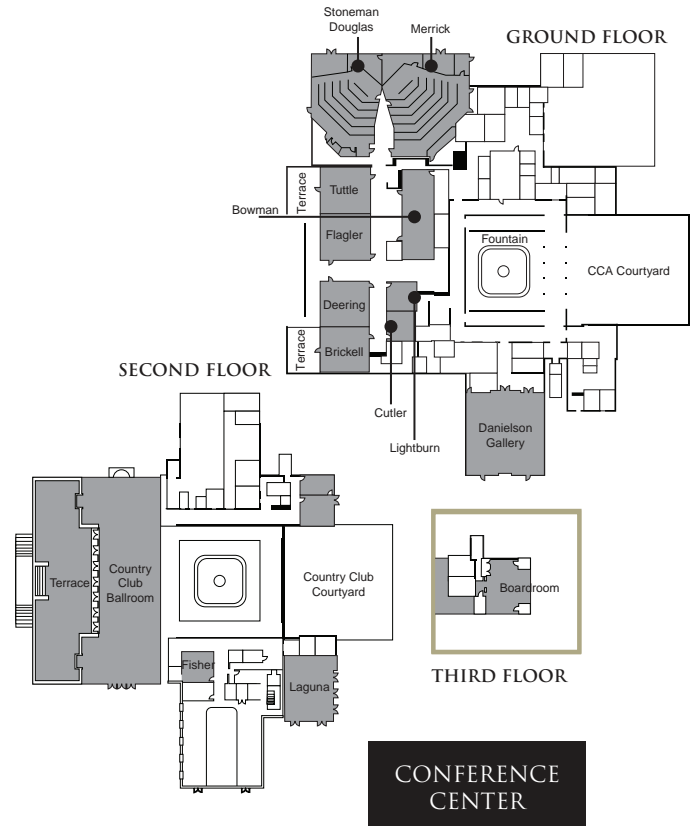
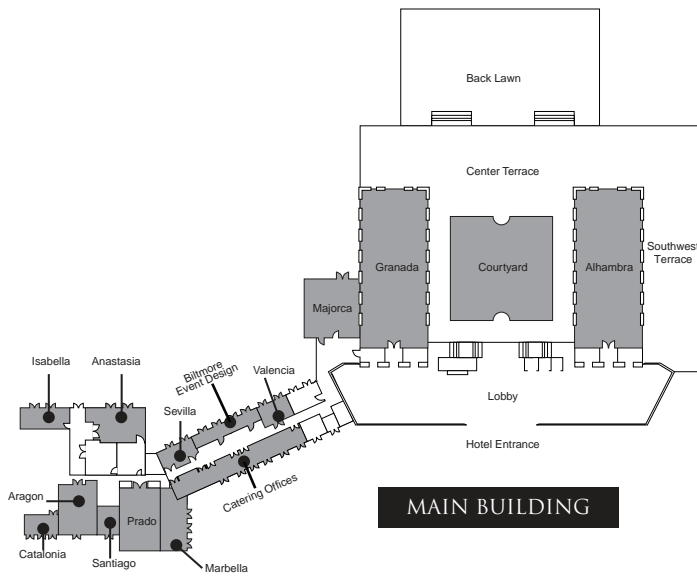

The Biltmore offers more than 76,000 square feet of indoor/outdoor meeting and function space, set amidst the hotel's historic ambiance. The facilities are housed within two locations on the Biltmore grounds – within the hotel itself and at the adjacent Conference Center of the Americas (CCA).

The hotel features elegant twin ballrooms with scenic outdoor terraces. Meeting rooms of various sizes are conveniently located along one wing on the lobby level. All operational systems and services are integrated between the Biltmore and the CCA so that attendees enjoy meeting and hotel experiences of outstanding quality.

The Conference Center of the Americas offers exceptional function space including two state-of-the-art amphitheatres, breakout rooms, a grand ballroom, an executive boardroom and the hotel's business center.

All meeting rooms are supported by powerful technology including wired and wireless high-speed Internet and videoconferencing capability. Three elegant classrooms offer built-in LCD rear-screen projection and advanced sound.

The two, tiered amphitheatres, seating 60-90 and 90-120 persons, provide dedicated wireless simultaneous translation and audience response systems. Every participant station is wired for 120 v., Ethernet, analog phone lines and personal task lighting. Both amphitheatres have rear-screen projection, full audio support and complete remote control of the room from each speaker's podium.

ROOM	ROOM DETAIL	SQ. FEET	SQ. METERS	CONFERENCE	RECEPTION	THEATER	CLASSROOM	U-SHAPE	HOLLOW SQ.	ROUNDS	
<b>Main Building</b>		L x W x H									
Alhambra	96 x 39 x 25	3744	347	86	500	400	200	90	100	270	
SW Terrace	--	6490	603	--	500	200	--	--	--	350	
Granada	96 x 39 x 25	3744	347	86	500	400	200	90	100	280	
Center Terrace	--	5811	540	--	500	200	--	--	--	350	
Back Lawn	--	2396	223	--	200	200	--	--	--	160	
Majorca	35 x 24 x 10	852	79	28	70	70	50	32	40	60	
Marbella	35 x 19 x 8	701	65	28	60	80	40	30	36	60	
Prado	48 x 28 x 9	1373	128	40	100	120	80	48	58	80	
Anastasia	34 x 21 x 9	734	68	28	60	70	48	30	40	60	
Santiago	17 x 14 x 9	262	24	12	--	18	8	--	--	12	
Aragon	40 x 28 x 9	1134	105	34	90	100	72	38	44	80	
Isabella	28 x 12 x 8	356	33	12	--	--	--	--	--	--	
Catalonia	23 x 15 x 9	365	34	10	--	--	--	--	--	--	
Valencia	23 x 14 x 11	334	31	8	--	--	--	--	--	--	
Sevilla	27 x 12 x 9	400	37	10	--	--	--	--	--	--	
<b>Conference Center</b>											
Stoneman Douglas	47 x 60 x 14	2496	232	--	--	--	60	--	--	--	
Merrick	59 x 65 x 14	3520	327	--	--	--	90	--	--	--	
Tuttle	31 x 29 x 9	929	86	24	80	70	40	30	38	60	
Tuttle Terrace	--	880	82	--	75	--	--	--	--	60	
Flagler	30 x 31 x 9	871	81	24	40	60	40	25	30	50	
Bowman	61 x 20 x 9	1271	118	50	120	120	72	54	60	100	
Deering	30 x 31 x 9	871	81	24	40	60	40	25	30	50	
Lightburn	20 x 18 x 8	385	36	16	--	32	20	16	20	20	
Brickell	31 x 29 x 9	934	87	24	80	70	40	30	38	60	
Brickell Terrace	--	880	82	--	75	--	--	--	--	60	
Cutler	20 x 18 x 8	385	36	10	--	--	--	--	--	--	
Danielson Gallery	57 x 51 x 19	2933/1900	272/176	44/44	350	200	72/60	50	58	200/120	
Boardroom	22 x 30 x 9	686	64	18	--	--	--	--	--	--	
CC Ballroom	136 x 48 x 46	6528	606	124	700	600	275	130	140	500	
CC Courtyard	--	10420	968	--	1000+	400	--	--	--	650	
CC Terrace	--	5560	517	--	500	350	--	--	--	350	
Laguna	46 x 32 x 16	1472	137	40	100	80	32	--	--	110	
Fisher	21 x 18 x 9	378	35	18	--	30	12	--	--	30	